



The 8th International Congress on Industrial and Applied Mathematics

ICIAM 2015

August 10-14 , 2015

Beijing , China

www.iciam2015.cn

WELCOME TO ICIAM 2015!

Dear friends,

Thank you for your participation in the Eighth International Congress on Industrial and Applied Mathematics! Welcome to Beijing!

It is fitting that ICIAM 2015 is being held in Beijing, China with its rich tradition in applied mathematics. This Congress is the first being held in China, in Asia as well as in developing countries.

In order to help you to enjoy the stay here, we prepared this brochure including information about the venue, transportation, hotels and restaurants nearby, general information along with tips of the city.

Our volunteers in green T-shirts are always ready to provide you with help and advice. You could find them at the registration desk and in meeting areas.

Wish you a happy time in Beijing!

With best regards,
ICIAM 2015 Secretariat



INDEX

General Information about Beijing	2
Arrival and Public Transportation	3
ICIAM 2015 Information	7
Restaurants around the CNCC Complex	10



General Information about Beijing

INSURANCE

All participants are strongly recommended to arrange for medical and travel insurance for the duration of their stay in China. The committees and the ICIAM will not accept liability for sickness, personal injuries sustained, accidents, or for loss or damage to personal belongings of participants and their guests either during or as a result of the ICIAM 2015.

LANGUAGE

Chinese Mandarin is the official language both in Beijing and other cities in China. But like in many other cities, people in Beijing also have their own Beijing Dialect which is closely related to Mandarin.

ELECTRICITY

The electricity supply in China is 220V 50Hz. Most, but not all, sockets will accept both European and US style plugs.

WEATHER

Beijing weather in August is usually hot and humid, with an average daytime temperature of 30°C, decreasing to 18°C at night. In the evening, there may be occasional rain shower. The CNCC is air conditioned.

CURRENCY

RMB: There are 3 units of currency – Yuan, Jiao, Fen – and most prices are expressed in terms of RMB Yuan. Current exchange rate is 1USD = RMB 6.2089 Yuan as at 30 July 2015. Updated information may be found at the website <http://www.ebeijing.gov.cn/BeijingInformation/>

BEIJING FAST PRICES

Below are some examples of Beijing commodity prices in 2015. Whilst the list is not complete or exhaustive, it will just give you an idea what to expect when paying for shopping, food and local transportation when touring around the city.

Unit	RMB	Euro(approx)	USD(approx)
A bag of potato chips	8	1.16	1.29
A can of cola	3.5	0.51	0.56
A bottle of mineral water	2	0.29	0.32
A bottle of Beijing beer	3.5	0.51	0.56
A box of Nescafe ice cream	30	4.34	4.83

A bottle of local wine	35-180	5.06-26.05	5.64-29.00
A bottle of imported wine	100-400	14.47-57.88	16.11-64.44
The above prices refer to those in supermarkets and do not refer to special deals which are frequently available			
A cup of coffee	25	3.63	4.03
A Mcdonald's Big Mac	16	2.33	2.58
A Peking Roast duck	98	14.18	15.79
A meal in a local restaurant*	50-100	7.24-14.47	8.06-16.11
Taxi Flagfall and (per km)	13 (2.3 per km)	1.89 0.33 per km	2.09 0.37 per km
A Subway ticket	3-8	0.43-1.16	0.48-1.29
An urban bus ticket	2	0.28	0.32

Arrival and Public Transportation

ICIAM 2015 Airport Welcome Desks

Sunday, August 9	07:00-22:00	Exits of International Arrival at Terminal 2 and Terminal 3
Monday, August 10	07:00-20:00	Exits of International Arrival at Terminal 2 and Terminal 3

※ There will be volunteers at the exits of international arrival at T2 and T3. Please try to find the sign like right to meet them. They will show you the way to taxis, airport shuttles and airport express.

Transportation from the airport to China National Convention Center (CNCC) and hotels

1. Taxi: costs about 100RMB

(Please show the words below to a taxi driver if necessary.)

请送我去[国家会议中心](#)。

(Please take me to [China National Convention Center](#).)



The venue and hotels in Chinese

Destination	Destination in Chinese	Fare	Address of the Destination in Chinese
CNCC	国家会议中心	RMB 70-80	北京市朝阳区奥林匹克公园天辰东路7号 电话: 84373300
CNCC Grand Hotel	国家会议中心大酒店		北京市朝阳区北辰西路8号院1号楼 电话: 84372008
Intercontinental Beijing Beichen	北辰洲际酒店		北京市朝阳区北辰西路8号院4号楼 电话: 84371284
Celebrity International Grand Hotel	名人国际大酒店		北京市朝阳区亚运村安立路99号 电话: 58651166
North Star Continental Grand Hotel	北辰五洲大酒店		北京市朝阳区北辰东路8号 电话: 84985588-72049

Huiyuan PrimeHotel, Building D	汇园公寓媒体村	北京市朝阳区安定门外北辰东路8号 电话: 64992688
Huiyuan Service Apartment, Building N		
Yayuncun Hotel, Building A	亚运村宾馆	北京市朝阳区安定门外北辰东路8号 电话: 64991199
Holiday Inn Express Beijing Minzuyuan	北京民族园智选假日 酒店	北京市朝阳区民族园路1号1号楼 电话: 59269090



China National Convention Center
No.7 Tianchen East Road,Olympic
Green,Chaoyang District,Beijing
100105

国家会议中心
北京市朝阳区奥林匹克公园天辰东路7号

CNCC Grand Hotel
Building 1, No.8 Precincts,
Beichen West Road,Chaoyang
District, Beijing 100105, China

国家会议中心大酒店
北京市朝阳区北辰西路8号院1号楼

电话/Tel. (86 10) 8437 2008
(86 10) 8437 3300
传真/Fax. (86 10) 8437 0387
www.cnccgrandhotel.com
www.cnccchina.com

You can show the information to
the taxi driver to take you to the
hotel:

如您选择乘坐出租车, 请将以下行车
路线出示给司机:

- 1、沿首都机场高速一直到北四环, 亚运村方向出口
- 2、沿四环主路西行, 过安慧桥后出主路至北四环中路辅路
- 3、沿北四环中路辅路走约1公里, 在北辰西桥下右转至北辰西路
- 4、沿北辰西路北行至大屯路口辅路右转既是国家会议中心大酒店大堂



请带我去
Please take me to: 国家会议中心 CNCC 国家会议中心大酒店 CNCC Grand Hotel

Some other places in Chinese

The Palace Museum (The Forbidden City)	故宫	National Stadium (Bird Nest)	鸟巢
Summer Palace	颐和园	The Great Wall	长城
The Temple of Heaven in Beijing	天坛	Tsinghua University	清华大学
Beihai Park	北海公园	Peking University	北京大学

2. Airport Shuttle

Tickets Offices (From BCIA): T2: Gate No.11 (outside) on F1

T3: Gate No.7 or No.9 (Outside) on F1

① To CNCC/CNCC Grand Hotel/Intercontinental Beijing Beichen

Destination	Shuttle Line	Fare	Direction
CNCC	Line 6 (ShangDi& Olympic Village)	RMB 24	Time: 5:20-20:00. Every 40 minutes. Buses depart when fully seated. Get off at the stop Olympic Village, walk for 800 meters.
CNCC Grand Hotel			
Intercontinental Beijing Beichen			



②To Celebrity International Grand Hotel/North Star Continental Grand Hotel/Huiyuan Apartment/Yayuncun Hotel

Destination	Shuttle Line	Fare	Direction
Celebrity International GrandHotel	Line 5 (Zhongguancun)	RMB 21	Time: 6:50~The next day1:00, every 30 minutes. Buses depart when fully seated. (From 21:00 to 24:00, buses stop over at Guangshun North Street and Huguang Middle Street.) Get off at the stop Asian Games Village (Anhui Bridge), walk for 500-1000 meters.
North StarContinental Grand Hotel			
Huiyuan Prime Hotel, Building D			
Huiyuan Service Apartment, Building N			
Yayuncun Hotel, Building A			



3. Airport Express

① To CNCC/CNCC Grand Hotel/Intercontinental Beijing Beichen

Take the Airport Express. Change to subway Line 10 (towards Taiyanggong) at **Sanyuanqiao** transfer station, then to subway Line 8 (towards Olympic Sports Center) at **Beitucheng** transfer station, and get off at **Olympic Green** station. Leave the station by **Exit E** and walk towards the west for about 50 meters to the China National Convention Center.

② To Holiday Inn Express Beijing Minzuyuan

Take the Airport Express. Change to subway Line 10 (towards Taiyanggong) at **Sanyuanqiao** transfer station, and get off at **Beitucheng** station. Leave the station by **Exit D2** and walk for about 640 meters to the hotel.

Beijing Subway Map



北京地铁线路图 Beijing Subway Map

- 图例:
- 地铁一号线
 - 地铁八通线
 - 地铁四号线
 - 地铁大兴线
 - 地铁六号线
 - 地铁九号线
 - 地铁十三号线
 - 地铁十五号线
 - 地铁昌平线
 - 地铁房山线
 - 地铁亦庄线
 - 地铁S1线
 - 机场线
 - 地铁二号线
 - 地铁五号线
 - 地铁八号线
 - 地铁十号线
 - 地铁十四号线
 - 地铁15号线
 - 地铁房山线
 - 地铁亦庄线
 - 地铁S1线
 - 换乘站



温馨提示: 14号线七里庄站暂缓开通

ICIAM 2015 Information

1. The Executive Committee Office and ICIAM 2015 Secretariat

The Executive Committee Office and the Secretariat are located in room VIP 1-1 on level 1 of the China National Convention Center (CNCC). The office will be open during the daily schedule of meetings.

2. Registration Desk – Opening Hours

The ICIAM 2015 Registration Desk is located on level 1 of CNCC. Registration Desk opening hours are as follows:

Sunday, 9 August	10:00 - 20:00
Monday, 10 August	07:30 - 19:00
Tuesday, 11 August	08:00 - 19:00
Wednesday, 12 August	08:00 - 19:00
Thursday, 13 August	08:00 - 19:00
Friday, 14 August	08:00 - 12:00

3. Badges

As a Congress participant, you will be identifiable by your name badge. This badge permits you access to general sessions and activities, unless special tickets are provided. Participants are expected to wear their name badge at all times. In case of loss, please request a new name badge at the registration desk.

4. Tickets

For some events, the organizers will provide tickets (social events, tours) upon registering. Please present the relevant ticket upon request. If you are not able to present such ticket, you may be refused access to this function.

5. Security

Security measures at CNCC require that you and/or any bags you are carrying are subject to scanning upon entering the venue. Please respect instructions from security staff. The entrance for the Congress is C1.

6. Schedule Changes

At times, it may be necessary for the organizers to cancel, reschedule, or substitute a Congress session, speaker, theme or topic as announced in the scientific program. The organizers will provide advance notice of any changes, but cannot be held responsible

7. Business Center

Printing, copying and other office services are offered at the business center located on level 3 of the CNCC. Kindly note the Business Center will not open on August 13 due to another activity.

8. First aid, Medical Assistance

Delegates in need of medical treatment should contact the First Aid Point located in room VIP 1-1.

9. Lost and Found

Please take any found articles to the registration desk or inquire there for lost articles. Found items not collected at the end of the day will be handed to the CNCC security staff. We recommend that you label your conference bag.

10. Coffee Break

✓ Morning coffee break is scheduled from 9:30 – 10:00 at both North and South Foyer on level 3

- ✓ A lunch break is scheduled from 12:10 – 13:30
- ✓ Afternoon coffee break is scheduled from 15:30-16:00 at both North and South Foyer on level 3
- ✘ There will be no coffee break in the morning of August 10. Instead, the Executive Committee will provide lunch boxes to all participants. The dining area is Exhibition Hall 5 on level B1.

11. Session Rooms

Opening Ceremony	Plenary Hall A
Invited, Prize, Special Lectures	Ballrooms A, B, C
Registration Desk	Main Lobby on Level 1
Public computer area	Near Business Center
Office and the Secretariat	VIP 1-1
Speaker Ready Room (SRR)	VIP 3-1
Exhibition	North Foyer on level 3
Closing Ceremony	Ballroom A

12. Presentation Management

All speaker presentations will be managed by M-Events. As a presenter at the Congress, you are kindly requested to upload your presentation(s) to an M-Events protected server. Your presentation is going to be transferred into the programmed lecture room and then could be displayed by your own click there.

A network-based presentation system will be employed for the ICIAM 2015, along with a conference-specific interface which will ensure perfect quality of all presentations. All rooms are equipped with the necessary technical requirements, and additional back-up systems. Please note that only under very special circumstances will personal laptops and/or external equipment be permitted.

The Speaker Ready Room (SRR) is located at VIP ROOM 3-1 on the 3rd floor of CNCC. You are welcome to visit the Speaker Ready Room to submit, amend or update your presentation(s). We highly recommend that you submit all finalized presentations to the SRR at least 3 hours prior to your scheduled presentation.

The SRR will be open during the following hours, with seasoned technicians available to serve you:

Sunday, 9 August	16:00 - 19:30
Monday, 10 August	08:00 - 19:30
Tuesday, 11 August	08:00 - 19:30
Wednesday, 12 August	08:00 - 19:30
Thursday, 13 August	08:00 - 19:30
Friday, 14 August	08:00 –15:30

13. WI-FI

In all areas of the venue, Wi-Fi (wireless network) will be available. Please choose 'CNCC FREE' to access.

14. Exhibition

The exhibition area is located North Foyer on level 3 of CNCC.

Opening hours	
Monday, 10 August	13:00 - 18:30
Tuesday, 11 August	08:00 - 18:30
Wednesday, 12 August	08:00 - 18:30
Thursday, 13 August	08:00 - 18:30
Friday, 14 August	08:00 - 18:00

15. Shuttle Bus

Shuttle buses will be arranged between Celebrity International Grand Hotel, Huiyuan Prime Hotel (Building D), Huiyuan Service Apartment (Building N), Yayuncun Hotel (Building A) and CNCC both in the morning and

evening. Please contact the hotels for more information.

16. Tours

For tour reservations, please sign up at the tour desk in the registration area.

Restaurants around the CNCC Complex

China National Convention Center (CNCC)

Small snacks, sandwiches and drinks may be purchased at the business center (level 3) or at the refreshment kiosks on level 3 of the Exhibition Center. The refreshment kiosks will be open at noon on August 10-12.

Xin'AO Shopping Center

This is the most convenient place for lunch, with 35 plus restaurants.

The underground Xin'AO Shopping Center is located in the Olympic Park across the street from the CNCC toward East side.

There is a Catering Street on floor H1 of the shopping center.

To go there, exit gate C1 of CNCC, go to subway No. 8 (underground) station through exit E, cross the subway station, enter the Xin'AO Shopping Center, walk to the east side until you see the Catering Street.



Restaurants in the Xin'AO Shopping Center				
	Restaurant	Picture	Type	Average Cost (For reference only)
1	豪尚豪牛排馆 Hao Shang Hao Beef Steak Restaurant		西餐 Beef Steak	70 CNY
2	鸟巢比萨 KRO'S LITE PIZZA		Pizza	

3	芝士分子 Cheese Fans		Pizza	
4	喜乐豆 XILEDUO		面包甜点 Bakery	20 CNY
5	贝拉维塔意大利餐厅 Bella Vista		意大利菜 Italian Restaurant	85 CNY
6	TWOSOME COFFEE		咖啡厅 Café	
7	麦当劳 McDonald's		小吃快餐 Fast Food	25 CNY
8	吉野家 YOSHINOYA		小吃快餐 Fast Food	25 CNY
9	思味浓 SEVEN NANA		小吃快餐 Fast Food	45 CNY
10	品奇比萨 The Pizza Company		Pizza	65 CNY
11	禾绿回转寿司 Leisure Restaurant		寿司/简餐 Japanese Food	70 CNY

12	食美汇美食广场 Food Court		小吃快餐 Chinese Fast Food	20 CNY
13	泡泡火锅 PAOPAO		火锅 Hotpot	45 CNY
14	纽约客美式餐厅 New Yorker		西餐 Beef Steak	125 CNY
15	东方饺子王 ORIENTE KING OF DUMPLINGS		饺子 Dumplings/ Jiaozi	45 CNY
16	拿渡麻辣香锅 Nadu		川菜 Sichuan cuisine	70 CNY
17	庆丰包子铺 Qing-Feng Steamed Dumpling Shop		小吃快餐 Chinese Fast Food	15 CNY
18	华天延吉餐厅 Hua Tian Yanji Restaurant		小吃快餐 Chinese Fast Food	20 CNY
19	护国寺小吃店 HUGUOSI NOSHERY		小吃快餐 Chinese Fast Food	20 CNY
20	香妃烤鸡 Xiang Fei Fast Food		小吃快餐 Chinese Fast Food	25 CNY

21	利昂法式铁板主题餐 FRENCH TEPPANYAKI		法国菜 French Cuisine	125 CNY
22	赛百味 SUBWAY		快餐 Fast Food	22 CNY
23	咖啡工场 Coffeepus		咖啡厅 Café	35 CNY
24	全面经典 Classic Food		小吃快餐 Chinese Fast Food	35 CNY
25	港品元素 Element H.K		粤菜 Cantonese	70 CNY
26	优渥天府 FLAVOR FOOD YOU WU		川菜 Sichuan cuisine	70 CNY
27	合利屋 Hollywood		小吃快餐 Chinese Fast Food	—
28	一碗居老北京炸酱面 YIWANJU—Noodles Of Fried Sauce Of Old Beijing		小吃快餐 Chinese Fast Food	50 CNY
29	顺口溜 Shun Kou Liu		西北菜 Chinese Cuisine	35 CNY

30	呷哺呷哺(新奥店) XiabuXiabu		小火锅 Hotpot	45 CNY
31	瀧麒沙盘烤 BBQ		BBQ	—
32	吾悦厨房 MY JOYFUL KITCHEN		粤菜 Cantonese	55 CNY
33	COSTA COFFEE		咖啡厅 Café	35 CNY
34	边境共和国 BORDER REPUBLIC		小吃快餐 Chinese Fast Food	65 CNY
35	小吊梨汤 Xiao Diao Li Tang		创意菜 Traditional Chinese	80 CNY

CNCC Grand Hotel

U Café – Designed in a contemporary setting the CNCC Grand Hotel's main restaurant features an international Buffet serving local favorites as well as a variety of other Asian and Western cuisines. Located adjacent to the Terrace where outdoor service can also be provided. Serving breakfasts from the start of the day seating can be extended by opening the dividing walls to the adjacent private function rooms.

Number of seats: 120, plus 20 seats in Function Room Genuine

Location in the hotel: Level 2

Open Hours: 07:00-23:00hrs daily

Chinese Tea Bar – A comfortable lounge area serving varieties of teas from all over China. Open throughout the day guests can sample the exotic flavors of such teas as Jasmine Rose Eun-joo.

Number of seats: 16

Location in the hotel: Level 2

Open Hours: 10:00-20:00hrs daily

Lounge and Lobby Bar – With a central bar area the Lounge is designed with comfortable corners and is an ideal environment for quiet discussions. Serving a full range of cocktails the circular bar provides a lively ambience at the end of the day.

Number of seats: 60

Location in the hotel: Level 1

Open Hours: 10:00-24:00hrs daily

Private Function Rooms – Four private function rooms offer an ideal environment for entertaining guests. A private driveway at Level 2 enables smooth direct access.

Function Room **Genuine**: Up to 16 for banquets

Function Room **Fidelity**: Up to 16 for banquets

Function Room **Treasure**: Up to 16 for banquets

Function Room **Superior**: Up to 26 for private Banquets

Location in the hotel: Level 2

The two rooms Fidelity and Treasure can combine to form one room to seat up to 32 for private Banquets

The function room Genuine can combine with the U Café to provide 20 further seats

Intercontinental Hotel, Beichen

Di - Chinese Cuisine, 84 Seats

Open Lunch & Dinner, Level 1

The average price for a la carte is at CNY28 for cold dish, CNY60 for meat, CNY55 for poultry, CNY60 for claypot, CNY45 for vegetable, CNY70 for rice noodle and CNY28 for dim sum.

Va Piano - Italian Cuisine, 70 Seats

Open Lunch & Dinner, Level 2,

The average price range is CNY138-168 plus 15% surcharge for the Main Dish and CNY218 plus 15% surcharge for the Main Grill.

Café O2 - International and Asian Buffet Cuisine, 100 Seats

Open Breakfast, Lunch & Dinner, Level 1



The average price range is CNY208 plus 15% surcharge per person for Buffet Lunch and CNY 228 plus 15%

surcharge per person for Buffet Dinner.

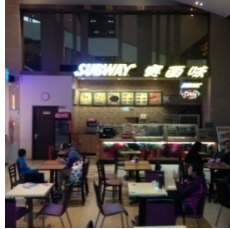
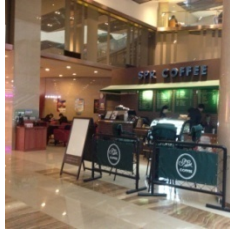

Around the Olympic Green area

The North Star Century Center which is located in the west of CNCC is an office building. There are several restaurants in both Tower A and B.

North Star Century Center				
	Restaurant	Picture	Type	Average Cost
1	世纪美食坊 Century Food Restaurant		小吃快餐 Chinese Fast Food	20 CNY
2	美国加州牛肉面大王 USA California Beef Noodles		小吃快餐 Fast Food	20 CNY
3	赛百味 SUBWAY		西式简餐 Fast Food	20 CNY
4	SPR COFFEE		咖啡厅 Café	30 CNY
5	盒乐弁当 HELE		小吃快餐 Chinese Fast Food	20 CNY

6	星巴克 StarBucks Coffee		咖啡厅 Café	40 CNY
7	馋厨 Chef Chrn		小吃快餐 Chinese Fast Food	35 CNY
8	觅唐餐厅 Cantonese M&E Restaurant		粤菜 Cantonese	90 CNY

Restaurants away from CNCC in less than 5 kilometers

The area shown in the following map is a very active commercial area with hundreds of restaurants. There are lots of restaurants along the roads marking with red lines.

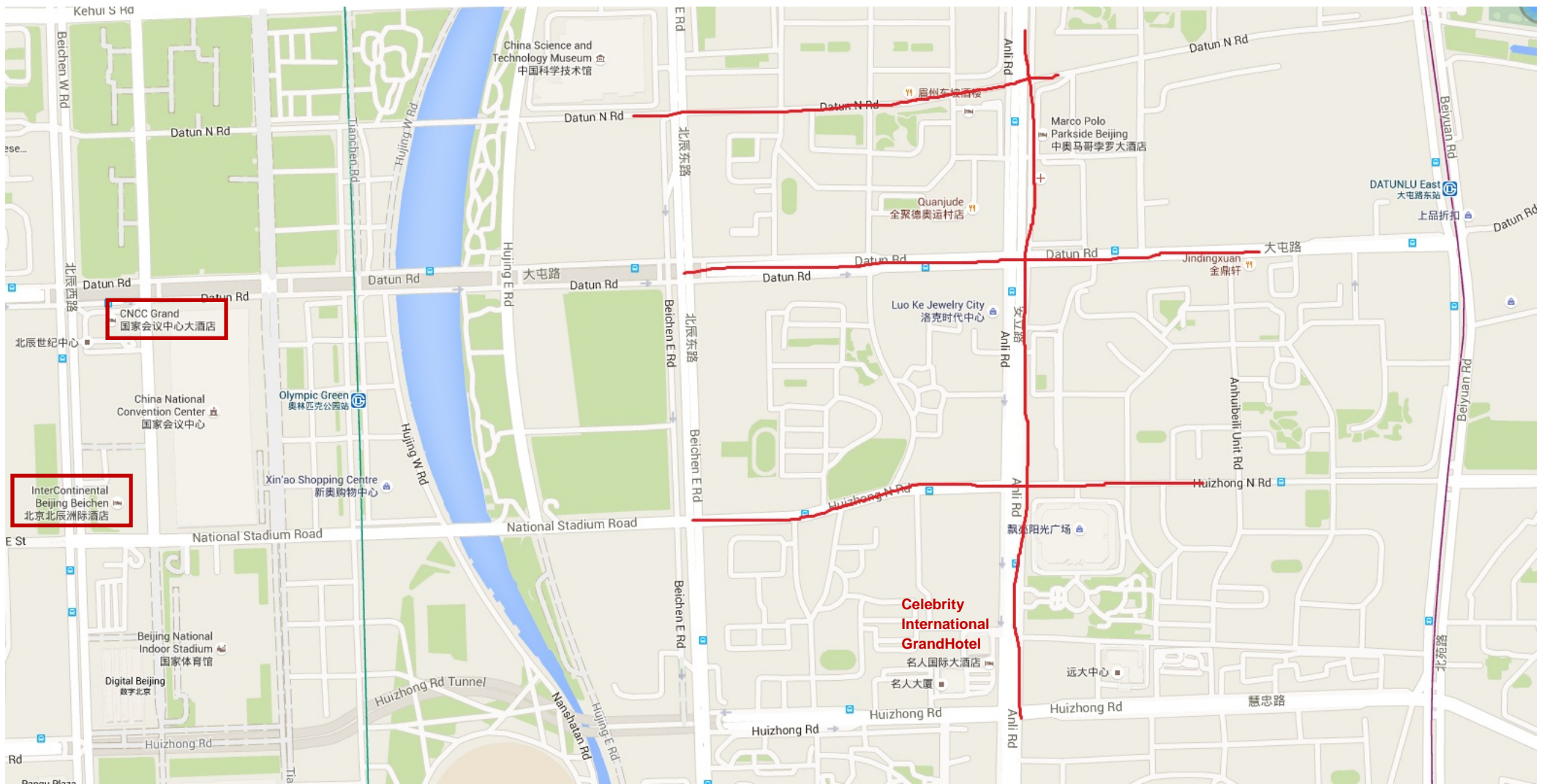

CNCC Floorplan

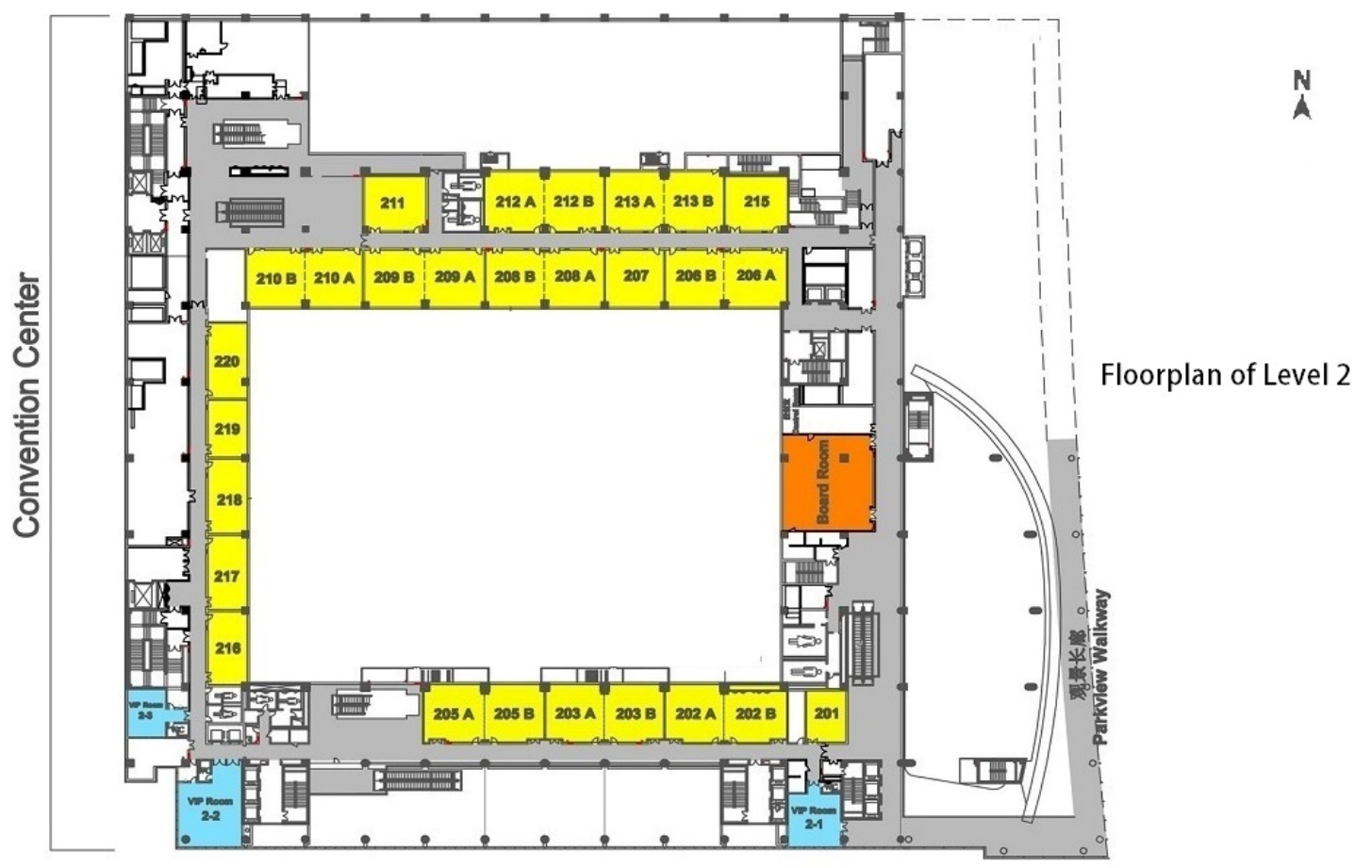
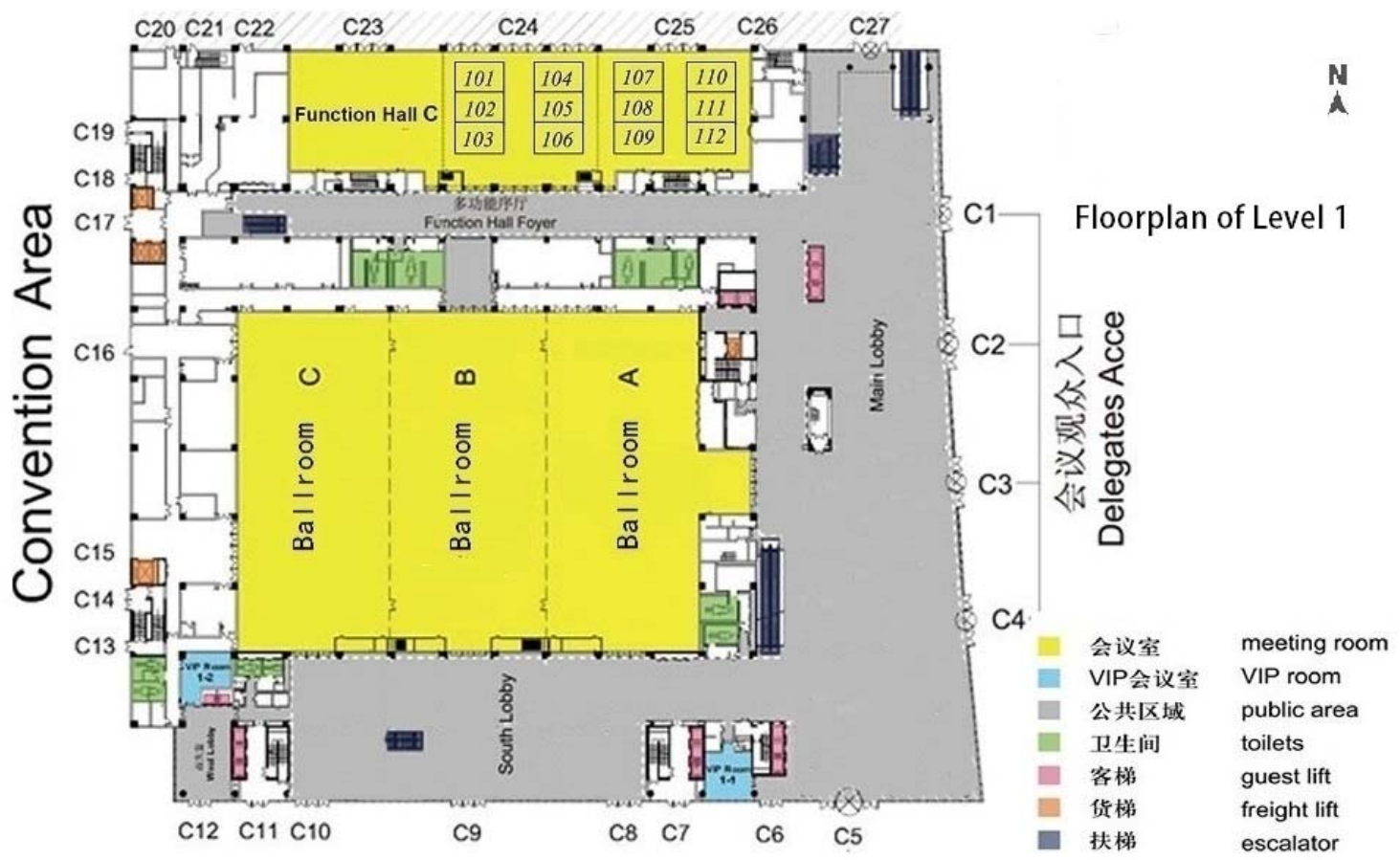

CNCC Floorplan

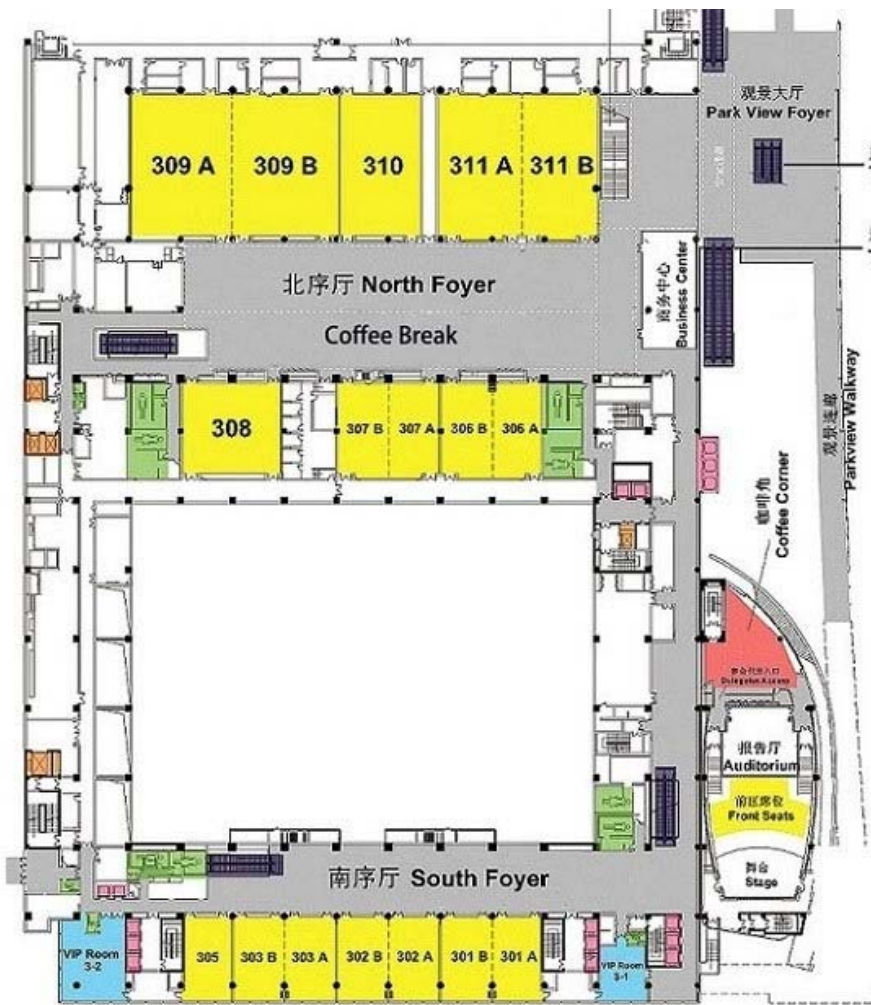

Floorplan of Level 3

- 会议室 meeting room
- VIP 会议室 VIP room
- 公共区域 public area
- 卫生间 toilets
- 客梯 guest lift
- 货梯 freight lift
- 扶梯 escalator
- * AB 会议室可连通
AB rooms can be combined

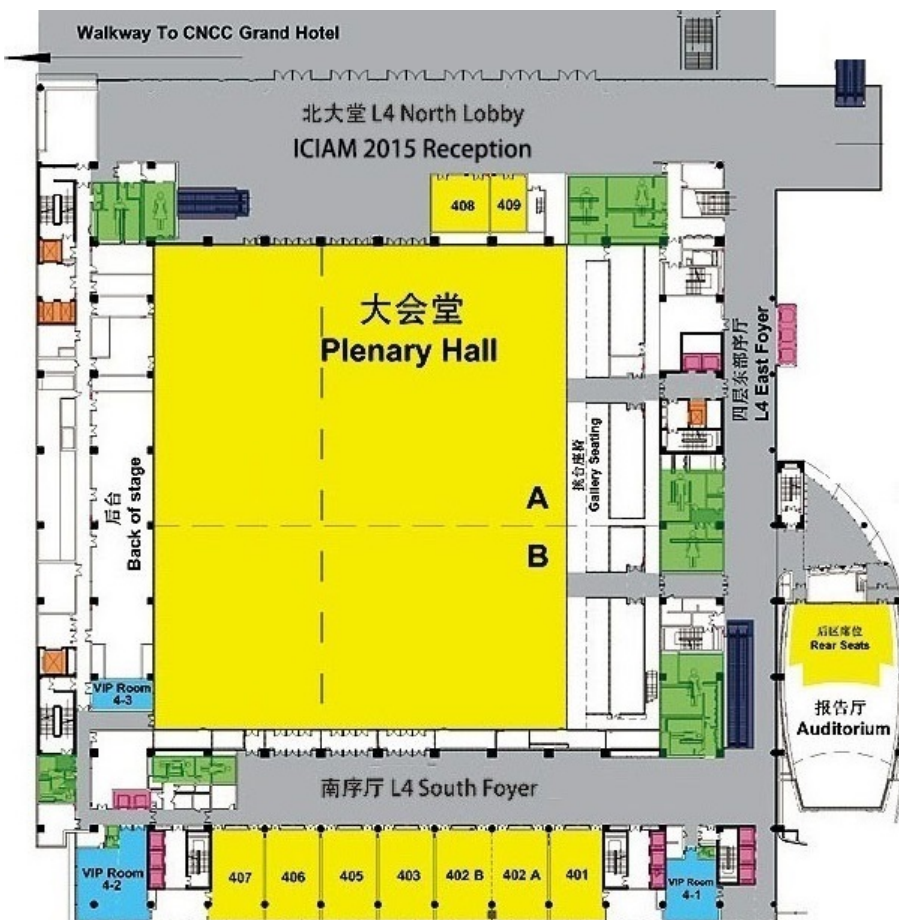

Floorplan of Level 4

- 会议室 meeting room
- VIP 会议室 VIP room
- 公共区域 public area
- 卫生间 toilets
- 客梯 guest lift
- 货梯 freight lift
- 扶梯 escalator
- * AB 会议室可连通
AB rooms can be combined